

5000/3 SGP Art. 1471

**D** **Gebrauchsanweisung**  
Duo-Pumpe

**GB** **Operating Instructions**  
Dual Pump

**F** **Mode d'emploi**  
Pompe universelle

**NL** **Gebruiksaanwijzing**  
Duopomp

**S** **Bruksanvisning**  
Universalpump

**I** **Istruzioni per l'uso**  
Pompa Duo

**E** **Manual de instrucciones**  
Bomba dúo

**P** **Instruções de utilização**  
Bomba dupla

**DK** **Brugsanvisning**  
Universalpumpe

# GARDENA Dual Pump 5000/3 SGP

Welcome to the Garden of GARDENA ...



Please read these operating instructions carefully and observe the notes given. Use these operating instructions to familiarise yourself with the Dual Pump, its correct use and the notes on safety.



For safety reasons, children under the age of 16 as well as persons not familiar with these operating instructions should not use this Dual Pump.

→ Please keep these instructions in a safe place.

## Contents

1. Where to Use Your GARDENA Dual Pump	11
2. For Your Safety	11
3. Initial Operation	13
4. Operation	14
5. Maintenance	14
6. Trouble-Shooting	14
7. Storage	16
8. Accessories	16
9. Technical Data	17
10. Service	17

## 1. Where to Use Your GARDENA Dual Pump

### Intended use

The GARDENA Dual Pump has been designed for private use around house and garden.

### Liquids to be pumped

The GARDENA Dual Pump can be used for pumping rainwater, tap water or chlorinated swimming pool water.

The pump is fully submersible (waterproof sealed) and can be immersed in the liquid down to a depth of 9 m.

### Please note



**The GARDENA Dual Pump is not designed for continuous operation (e.g. industrial application, continuous circulating operation). Corrosive, easily combustible, aggressive or explosive substances (e.g. gasoline, petroleum or nitro thinner), salt water as well as food must not be pumped. The temperature of the liquid should not exceed 35 °C.**

## 2. For Your Safety

### Residual-current device

According to DIN VDE (German Electrical Engineers' Association) 0100, submersible pumps may only be used in swimming pools, garden ponds, and fountains if the pump is operated via a residual-current device with a residual-current rating of  $\leq 30$  mA. The pump must not be operated when there are persons in the swimming pool or garden pond.

For safety reasons we recommend that you always operate the Dual Pump via a residual-current device (DIN VDE 0100-702 and 0100-738).

→ Please contact your electrician.

#### In Austria

In Austria, according to ÖVE B/EN 60 555 part 1 to 3, pumps which are used in swimming pools and garden ponds, and equipped with firm power cable should be fed via an ÖVE approved isolating transformer – rated voltage must not exceed 230 V.

#### In Switzerland

In Switzerland mobile appliances which are used outdoors, must be connected via a residual-current device.

#### Mains power

According to DIN VDE (German Electrical Engineers' Association) 0620, mains power cables must not have a smaller cross-section than the rubber-sheathed cables of the designation H07 RNF. The cable length must be at least 10 m.

Data indicated on the type plate must match technical data of the mains supply.

→ Take care that the electrical connections are made within dry area, protected from flooding.

Protect plug and power cable from heat, oil and sharp edges.

→ Don't use the power cable for plugging off.

The power cable must not be used for mounting or relocating the pump. For submerging or lifting/securing the pump, fix a rope (available from GARDENA Service) to the pump's carrying handle.

Extension cables must meet the requirements of DIN VDE 0620.

#### Visual check

→ Before operating the pump, first make a visual check, if there is any damage of the pump (esp. regarding power cable and plug).

→ Observe the minimum water level and the max. delivery height (see 9. Technical Data).

A damaged pump must not be used.

→ In case of damage, please have the pump checked by our GARDENA Service Centre.

#### Note on use

→ Clear the outlet line before use.

#### When setting up the pump for use out of water

In order to avoid dry-running of the pump, take care that the end of the suction hose is always submerged into the liquid.

→ Before each operation, fill the pump to overflowing with approx. 2 l of the liquid to be pumped!

#### Liquid fails to flow

Sand and other abrasive substances in the liquid cause increased wear and reduce the pump's output.

→ Use a Pump Preliminary Filter if the water contains sand (Art. No. 1730/1731).

The pump should not run against the closed delivery side for more than 5 minutes.

→ If liquid fails to flow, switch off the pump immediately.

#### Minimum flow rate

The minimum flow rate is 80 l/h (= 1.3 l/min).  
Watering accessories with lower rate must not be operated.

#### Hot water – risk of scalding



If the pump is operated for prolonged periods of time (> 5 min) with the delivery side closed, the water in the pump may heat up so that there is a risk of scalding yourself with hot water.

→ The pump should not run against the closed delivery side for more than 5 minutes.

→ If liquid fails to flow, switch off the pump immediately.

## 3. Initial Operation

#### Connecting a filter or hose to the inlet side:

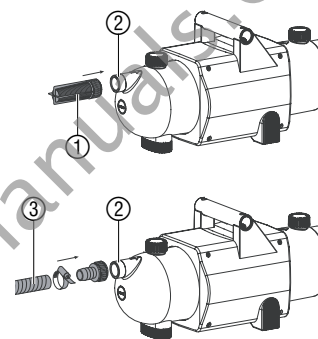

1. When setting up the pump **for use underwater**, screw the **filter** ① onto the connection ② at the inlet side of the pump.

– or –

When setting up the pump **for use out of water**, connect a **vacuum-resistant suction hose** ③ **with filter** to the connection ② at the inlet side of the pump and screw on so that the connection is air-tight.

2. When setting up the pump **for use out of water** with suction heights over 4 m, the suction hose should also be secured (fastened to a wooden peg for example).

*The pump is relieved of the weight of the suction hose.*

Don't use any hose connection system fittings on the suction side! A vacuum-resistant suction hose must be used

- e.g. GARDENA Suction Unit, **art. no. 1411**.

In order to reduce the suction time, it is advisable to use a suction hose with backflow preventer avoiding automatic draining of the suction hose when the pump is stopped.

Both pump connectors ④ are equipped with a 33.3 mm (G 1") thread to which 13 mm (1/2"), 19 mm (3/4") and 16 mm (5/8") hoses can be connected by using GARDENA hose connection system fittings.

#### Connection hose to delivery side:

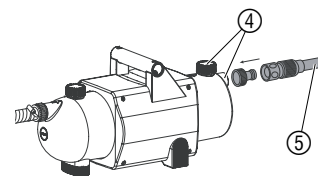

Best results regarding the delivery capacity of the pump are achieved when connecting 19 mm (3/4") hoses in conjunction with e.g.

- GARDENA Pump Connection Set, **art. no. 1752**, or when using 25 mm (1") hoses with fittings available from your sanitary dealer.

→ Connect the pressure hose ⑤ to the connector ④ on the delivery side.

#### Only when setting up the pump for use out of water:

→ Before each operation, fill the pump to overflowing with approx. 2 l of the liquid to be pumped!

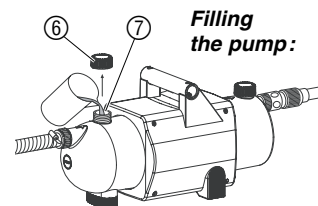

1. Unscrew the screw fitting ⑥ of the filler cap ⑦ by hand.
2. Fill the pump via the filler cap ⑦ to overflowing with approx. 2 l of the liquid to be pumped.
3. Tighten the screw fitting ⑥ of the filler cap ⑦ by hand (do not use pliers).

## 4. Operation

### Starting the pump:

#### When setting up the pump for use in water:

→ Plug the mains plug of the pump into a 230 V / 50 Hz alternating current socket. *The pump starts.*

### Pumping liquid:

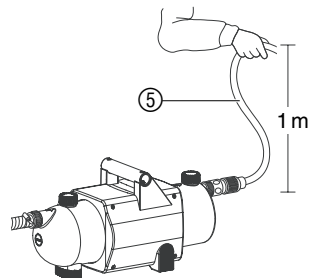

#### When setting up the pump for use out of water

1. Fill the pump to overflowing with approx. 2 l of the liquid to be pumped (see "3. Initial Operation", "Filling the pump").
  2. Open all possible shut-off devices in the pressure line (watering accessories, Water Stop, etc.).
  3. Drain remaining water in pressure hose so that air can escape during the suction process.
  4. Plug the mains plug of the pump into a 230 V / 50 Hz alternating current socket. *The pump starts.*
  5. Hold the hose ⑤ at the delivery side approx. 1 m vertically above the pump until the pump begins to pump.
- If the pump has still not started pumping after 7 minutes, unplug the mains plug (see 6. Trouble Shooting).

When using the pump for pressure intensification, the max. permissible internal pressure of 6 bar (on the delivery side) must not be exceeded. The to be increased delivery pressure and the pump pressure sum up.

- Example: pressure at the water tap 1.5 bar, max. pressure of the GARDENA Dual Pump 5000/3 SGP = 3.3 bar, total pressure = 4.8 bar.

## 5. Maintenance

The GARDENA Dual Pump is virtually maintenance-free.

## 6. Trouble-Shooting

### Freeing the impeller:

If the impeller blocks or clogs you can remove the dirt to free the impeller.

1. Unscrew the screw plug ⑧ using a screwdriver.
2. You can now turn the impeller shaft ⑨ in the casing using a screwdriver. *This will free the blocked or clogged impeller.*
3. Replace the screw plug ⑧ using a screwdriver.

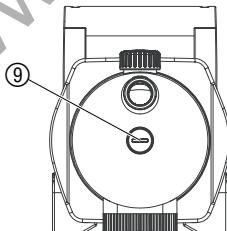
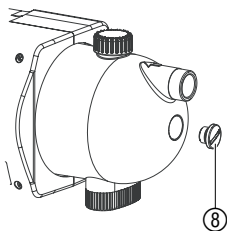

Problem	Probable cause	Remedy
<b>Pump runs, but the suction action doesn't take place.</b>	Air cannot escape, since delivery side is closed or remaining water is in the pressure hose.	→ Open all possible shut-off devices (e.g. spray nozzle) in the pressure line, or drain the pressure hose or disconnect it during the suction action.
<b>Pump runs when out of water but does not start pumping when in water</b>	You didn't fill the pump with any liquid before operation.  The liquid escapes over the hose which is connected to the delivery side during the suction action.	→ Fill in liquid (see point "3. Initial Operation").  1. Fill up the pump again (see point 3. Initial Operation). 2. When starting operation hold the pressure hose approx. 1 m vertically above the pump, until the suction action has taken place.
	Leaky or damaged suction hose.	→ Seal the connections or check suction hose for damages.  Absolutely vacuum-resistant connection is achieved by using GARDENA Suction Hoses (see point "8. Accessories").
	Leaky screw fitting at the filler cap ⑦.	→ Tighten the screw fitting (do not use pliers).
	Air cannot escape, since delivery side is closed or remaining water is in the pressure hose.	→ Open all possible shut-off devices (e.g. spray nozzle) in the pressure line, or drain the pressure hose or disconnect it during the suction action.
	The waiting time wasn't observed.	→ Switch on the pump and wait max. 7 min.
	Suction filter or backflow preventer in the suction hose clogged.	→ Clean the filter or the backflow preventer.
	Too high suction height.	→ Reduce suction height.
	In case of any other difficulties concerning the suction action, use GARDENA Suction Hoses with Backflow Preventer (see point "8. Accessories") and fill in the liquid to be pumped over the filler cap ⑦ before operation.	
<b>The specified maximum self-priming height is not</b>	Pump is not filled and suction hose is not held upwards.	1. Fill the pump using the filler neck until it overflows.  2. Hold the suction hose upwards during the self-priming phase so that the liquid you are going to pump cannot flow out of the pump via the suction hose.

Problem	Probable cause	Remedy
<b>Pump motor runs, but delivery capacity or pressure suddenly decreases.</b>	Suction filter at the suction hose is sucked free.	→ Reduce flow rate on the delivery side with a regulator valve, e.g. GARDENA art. no. (2)977.
	Suction filter or backflow preventer clogged.	→ Clean filter or back-flow preventer.
	Impeller blocked.	→ Free the impeller.
<b>Pump motor doesn't start or suddenly stops.</b>	No power.	→ Check fuses and electric connections.
	Thermal overload switch has cut out the pump due to overheating/overloading.	→ Free the impeller and open the pressure side.
	Impeller clogged.	→ Send the pump to one of our GARDENA Service Centres.
	Electric failure.	→ Send the pump to one of our GARDENA Service Centres.

**Attention!**

Repairs on electrical parts should only be done by our GARDENA Service Centres.

If you have any problems with your pump, please contact our Service.

## 7. Storage

### Wintering/Storage:

Empty your Dual Pump before the first frost sets in.

1. Hold the pump diagonally and drain the water from the pump out of the inlet side.
2. Store your Dual Pump in a place that is protected from frost.

## 8. Accessories

<b>GARDENA Suction Hoses</b>	Kink- and vacuum-resistant, sold by the metre with 19 mm (3/4") or 25 mm (1") diameter without fittings or in fixed length, complete with fittings.	
<b>GARDENA Suction Hose Fittings</b>		• Art. no. 1723 / 1724
<b>GARDENA Suction Filter with Backflow Preventer</b>	To equip suction hoses sold by the metre.	• Art. no. 1726 / 1727 / 1728
<b>GARDENA Pump Preliminary Filter</b>	Recommended for pumping sandy liquids.	• Art. no. 1730 / 1731
<b>GARDENA Electronic Manometric Switch</b>	Automatically cuts in and out the pump depending on the current operating pressure. With dry-running safety.	• Art. no. 1739
<b>GARDENA Dry-Running Safety</b>	Prevents the pump from damages in case of missing liquid.	• Art. no. 1741

## 9. Technical Data

	<b>5000/3 SGP (Art. 1471)</b>
<b>Rated power</b>	750 W
<b>Max. delivery capacity</b>	5,200 l/h
<b>Max. pressure</b>	3.3 bar
<b>Max. delivery head</b>	33 m
<b>Max. self-priming suction height</b>	8 m
<b>Perm. internal pressure (delivery side)</b>	6 bar
<b>Voltage</b>	230 V AC
<b>Frequency</b>	50 Hz
<b>Weight</b>	7.8 kg
<b>Noise level L<sub>WA</sub><sup>1)</sup></b>	66 dB (A)

1) Measuring method according to Directive 2000/14/EC

### Performance characteristics

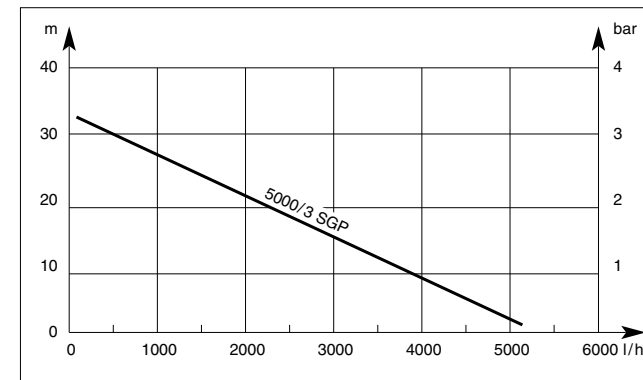

## 10. Service

### Warranty

GARDENA guarantees this product for 2 years (from date of purchase). This guarantee covers all serious defects of the unit that can be proved to be material or manufacturing faults. Under warranty we will either replace the unit or repair it free of charge if the following conditions apply:

- The unit must have been handled properly and in keeping with the requirements of the operating instructions.
- Neither the purchaser or a non-authorized third party have attempted to repair the unit.

The impeller is a wearing part and is not covered by the guarantee. This manufacturer's guarantee does not affect the user's existing warranty claims against the dealer/seller.

If a fault occurs with your Dual Pump, please return the faulty unit together with a copy of the receipt and a description of the fault, with postage paid to one of the GARDENA Service Centres listed on the back of these operating instructions.

#### **Product Liability**

We expressly point out that, in accordance with the product liability law, we are not liable for any damage caused by our units if it is due to improper repair or if parts exchanged are not original GARDENA parts or parts approved by us, and, if the repairs were not carried out by a GARDENA Service Centre or an authorised specialist. The same applies to spare parts and accessories.

#### **EU Certificate of Conformity**

The undersigned GARDENA Kress + Kastner GmbH · Hans-Lorenser-Str. 40 · D-89079 Ulm hereby certifies that, when leaving our factory, the unit indicated below is in accordance with the harmonised EU guidelines, EU standards of safety and product specific standards.

This certificate becomes void if the unit is modified without our approval.

<b>Description of the unit:</b>	Dual Pump
<b>Type:</b>	5000/3 SGP
<b>Art. No.:</b>	1471
<b>EU directives:</b>	Machinery Directive 98/37/EC Electromagnetic Compatibility 89/336/EC Low Voltage Directive 73/23/EC Directive 93/68/EC Directive 2000/14/EC
<b>Harmonised European standards:</b>	EN 292-1 EN 292-2 EN 60335-1 EN 60335-2-41
<b>Noise level:</b>	measured 66 dB (A) guaranteed 69 dB (A)
<b>Year of CE marking:</b>	2002

Ulm, 09.07.2002



Thomas Heintl  
Technical Dept. Manager

**Deutschland**

GARDENA Kress + Kastner GmbH  
GARDENA Service  
Hans-Lorenser-Straße 40  
D-89079 Ulm  
Produktfragen: (07 31) 490-123  
Reparaturen: (07 31) 490-290

**Argentina**

Argensem S.A.  
Venezuela 1075  
(1618) El Talar - Buenos Aires

**Australia**

NYLEX Consumer Division  
76-88 Mills Road  
P.O. Box 722  
Braeside 3195  
Melbourne, Victoria

**Austria**

GARDENA Österreich Ges. m.b.H.  
Stettnerweg 11-15  
2100 Korneuburg

**Belgium**

MARKT (Belgium) NV/SA  
Sterrebeekstraat 163  
1930 Zaventem

**Brazil**

M. Cassab  
Av. das Nações Unidas, 20.882  
Santo Amaro, CEP 04795-000  
São Paulo - S.P.

**Bulgaria / България**

ДЕНЕКС ООД  
Бул. "Г.М.Димитров" 16 ет.4  
София 1797

**Canada**

GARDENA Canada Ltd.  
100, Summerlea Road  
Brampton, Ontario  
Canada L6T 4X3

**Chile**

Antonio Martinic Y CIA. LTDA.  
Gilberto Fuenzalida 185 Loc.  
Las Condes - Santiago de Chile

**Costa Rica**

Compania Exim  
Euroiberoamericana S.A.  
350 Sur del Automercado  
Los Yoses  
San Pedro

**Cyprus**

FARMOKIPIKI LTD  
P.O. Box 7098  
74, Digeni Akrita Ave.  
1641 Nicosia

**Czech Republic**

GARDENA spol. s.r.o.  
Řípská 20a, č.p. 1153  
62700 Brno

**Denmark**

GARDENA Danmark A/S  
Naverland 8  
2600 Glostrup

**Finland**

Habitec Oy  
Martinkyläntie 52  
01720 Vantaa

**France**

GARDENA France  
Service Après-Vente  
BP 50080  
95948 ROISSY CDG Cedex

**Great Britain**

GARDENA UK Ltd.  
27-28 Brenkley Way  
Blezard Business Park  
Seaton Burn  
Newcastle upon Tyne NE13 6DS

**Greece**

Agrokip G. Psomadopoulos & Co.  
33a, Ifestou str.  
Koropi 194 00  
Athens

**Hungary**

GARDENA Magyarország Kft.  
Késmárk utca 22  
1158 Budapest

**Iceland**

Heimilistaeki hf  
Saetun 8  
P.O. Box 5340  
125 Reykjavik

**Republic of Ireland**

Michael McLoughlin & Sons  
Hardware Limited  
Long Mile Road  
Dublin 12

**Italy**

GARDENA Italia S.r.l.  
Via Donizetti 22  
20020 Lainate (Mi)

**Japan**

KAKUDAI Mfg. Co. Ltd.  
1-4-4, Itachibori Nishi-ku  
Osaka 550

**Luxembourg**

Magasins Jules Neuberg  
Grand Rue 30  
Case Postale No. 12  
Luxembourg 2010

**Netherlands**

GARDENA Nederland B.V.  
Postbus 50176  
1305 AD ALMERE  
**Neth. Antilles**  
Jonka Enterprises N.V.  
Sta. Rosa Weg 196  
P.O. Box 8200  
Curaçao

**New Zealand**

NYLEX New Zealand Limited  
Private Bag 94001  
South Auckland Mail Centre  
10 Offenhauser Drive  
East Tamaki, Manukau

**Norway**

GARDENA Norge A/S  
Postboks 214  
2013 Skjetten

**Poland**

GARDENA Polska Sp. z o.o.  
Szymanów 9 d  
05-532 Baniocza

**Portugal**

MARKT (Portugal), Lda.  
Recta da Granja do Marquês  
Edif. GARDENA  
Algueirão  
2725-596 Mem Martins

**Russia / Россия**

АО АМИДА ТТЦ  
ул. Мосфильмовская 66  
117330 Москва

**Singapore**

Variware  
Holland Road Shopping Centre  
227-A, 1st Fl., Unit 29  
Holland Avenue  
Singapore 1027

**Slovenia / Croatia**

Silk d.o.o. Trgovina  
Brodlišče 15  
1236 Trzin

**South Africa**

GARDENA South Africa (Pty.) Ltd.  
P.O. Box 11534  
Vorna Valley 1686

**Spain**

ANMI Andreu y Miriam S.A.  
Calle Pere IV, 111  
08018 Barcelona

**Sweden**

GARDENA Svenska AB  
Box 9003  
20039 Malmö

**Switzerland**

GARDENA Kress + Kastner AG  
Bitziberg 1  
8184 Bachenbülach

**Ukraine / Украина**

АОЗТ АЛЬЦЕСТ  
ул. Гайдара 50  
г. Киев 01033

**Turkey**

Dost Diş Ticaret Müessesilik A.Ş.  
Yeşilbağlar Mah. Başkent  
Cad. No. 26  
Pendik - İstanbul

**USA**

GARDENA  
3085 Shawnee Drive  
Winchester, VA 22604

1471-20.960.02/0021

© GARDENA Kress + Kastner GmbH  
Postfach 27 47, D-89070 Ulm  
<http://www.gardena.com>